

MAINTENANCE INSTRUCTIONS IMPACT WRENCH

MODEL MI-16M

TOKU

TOKU PNEUMATIC PRODUCTS

AIR HOSE AND HOSE CONNECTION:

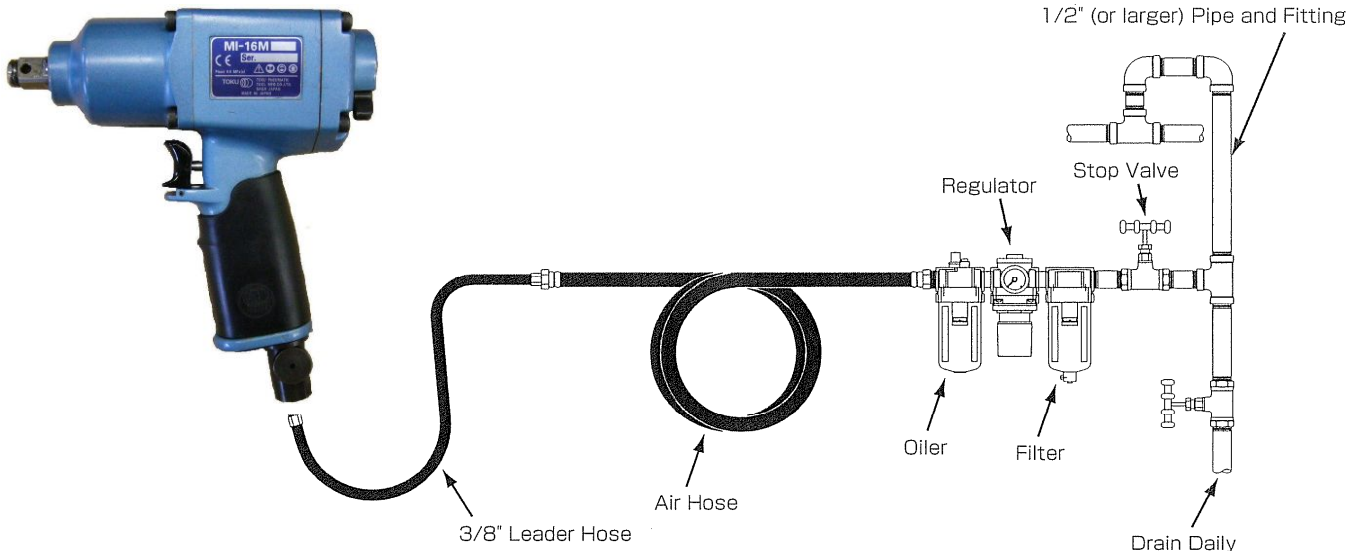

OPERATING INSTRUCTIONS



www.air-allied.com.au

“WARNING”

1. ALWAYS USE APPROVED EYE PROTECTION WHEN OPERATING THIS TOOL.
2. ALWAYS USE IMPACT SOCKETS IN GOOD CONDITION. SOCKETS IN BAD CONDITION REDUCE IMPACT POWER AND COULD ALSO SHATTER AND CAUSE POSSIBLE PERSONAL INJURY. NEVER USE HAND SOCKETS.
3. ALWAYS USE THE SIMPLEST HOOKUP POSSIBLE. LONG, SPRINGY EXTENSION BARS ABSORB IMPACT AND COULD BREAK LOOSE AND CAUSE POSSIBLE PERSONAL INJURY.
4. ALWAYS DIRECT EXHAUST AWAY FROM YOURSELF AND OTHERS IN THE AREA.
5. ALWAYS DISCONNECT TOOL WHEN NOT IN USE.

LUBRICATION

To flush out gum and dirt:

1. Daily before and after each shift, pour a liberal quantity of gum solvent oil into air line.
2. Connect tool to air line. Operate tool.
3. Repeat procedure before storing.
4. Monthly, check oil in impact unit.
5. At the timing of service, check oil class and q'ty if they are in accordance with the description below.
 - Oil class : Diesel motive S-320
 - Quantity in impact unit : 6 cc

AIR SUPPLY

1. Supply tool with 0.6MPa of clean, dry air, Higher pressure drastically reduces tool life and can void warranty.
2. See diagram above for Pipe, Hose and Fitting size.
3. When using two or more tools, Air Hoses should be larger than Leader Hose.

LOSS OF POWER/ERRATIC ACTION (possible causes)

1. Reduced compressor output.
2. Excessive drain on air line.
3. Moisture or restricted pipe, hose or fittings.
4. Improper size or poor condition of pipe, hose or fittings
5. Dirt or gum deposits cut tool power. To correct this, check and clean air strainer, then repeat lubrication procedure. (If outside conditions are in order, disassemble tool, replace worn or damaged parts, clean, assemble and lubricate.)

REPLACEMENT PARTS

Always use GENUINE TOKU TOOLS Replacement Parts.

When replacement parts are required, order by Part No. and Description in the Parts List.

SOUND LEVEL

Sound Level dB(A) in accordance with ISO 15744 : Pressure 89
Power 100

VIBRATIONS LEVEL

Vibration m/s^2 in accordance with ISO 8662-7 : 5.2

MAINTENANCE INSTRUCTIONS

1/2" IMPACT WRENCH

MODEL MI-16M

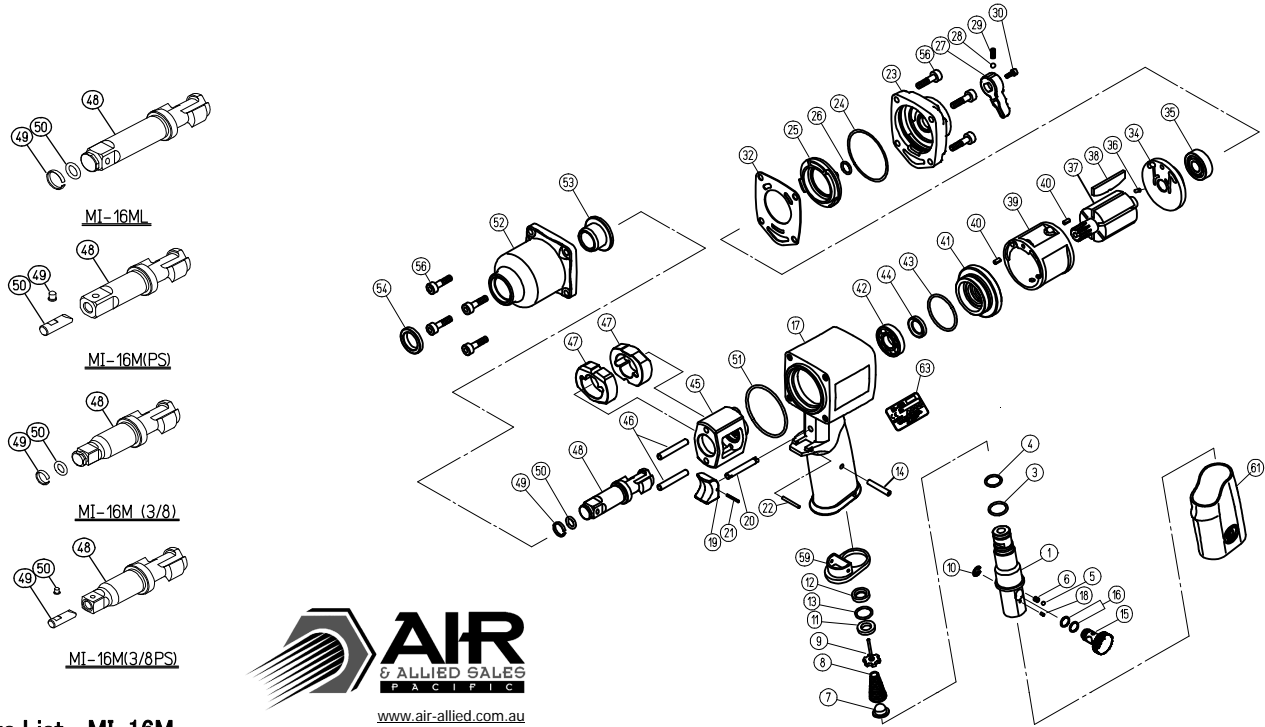
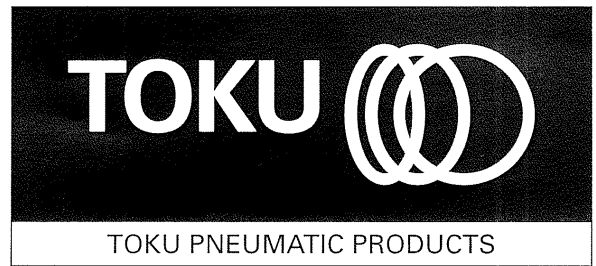

Parts List MI-16M

Symbol No.	Parts No.	Description	Q'ty Req	Symbol No.	Parts No.	Description	Q'ty Req
1	43-17-06-060	Air Inlet (PT)	1	45	43-17-02-440	Hammer Frame	1
3	13-11-03-012	O Ring S-14	1	46	43-17-02-460	Hammer Pin	2
4	13-11-03-010	O Ring S-12	1	47	43-17-02-450	Hammer	2
5	13-05-01-003	Steel Ball M3	1	48	43-17-05-500	Anvil Shank	1
6	13-08-09-005	Spring 3X4(0.4)	1	49	13-08-05-006	Socket Retainer	1
7	13-68-03-049	Air Screen	1	50	13-11-05-006	O Ring 6227-6	1
8	13-08-03-202	Throttle Valve Spring	1	51	13-11-03-037	O Ring S-46	1
9	13-68-05-003	Throttle Valve	1	52	43-17-02-520	Clutch Housing	1
10	13-03-03-006	Retaining Rings-Etype	1	53	43-17-02-490	Shank Bushing	1
11	13-68-04-009	Throttle Valve Seat	1	54	13-12-42-001	Oil Seal VB16244	1
12	43-17-02-D80	Throttle Valve Spacer	1	56	13-17-05-020	Hex Socket Head Cap Screw M5X20	8
13	13-11-03-011	O Ring S-12.5	1	59	13-74-03-021	Exhaust Deflector	1
14	13-06-04-025	Spring Pin 4X25	1	61	13-66-07-061	Grip Rubber	1
15	43-17-06-150	Regulator Valve	1	63	13-73-05-100	Name Plate	1
16	13-11-03-004	O Ring S-6	2	43-17-05-50C	Anvil shank CP(Incl. Index No.48,49&50)		
17	43-17-02-011	Motor Housing	1	43-17-02-52C	Clutch Housing CP(Incl. Index No.52,53&54)		
18	13-06-02-004	Spring Pin 2X4	1				
19	13-67-03-071	Trigger	1	MI-16ML(RH)			
20	43-17-02-100	Throttle Push Pin	1	48	43-17-08-500	Anvil Shank L (RH)	1
21	13-06-01-134	Spring Pin 1.6X14	1	49	13-08-05-006	Socket Retainer	1
22	13-06-02-020	Spring Pin 2X20	1	50	13-11-05-006	O Ring 6227-6	1
23	43-17-02-350	Housing Cover	1	43-17-08-50C	Anvil Shank CP(Incl. Index No.48,49&50)	(1CP)	
24	13-11-03-037	O Ring S-46	1	MI-16M(PS)			
25	43-17-02-210	Reverse Valve	1	48	43-17-04-500	Anvil Shank	1
26	13-11-03-007	O Ring S-9	1	49	43-18-16-610	Retainer Pin	1
27	13-67-03-072	Reverse Valve Lever	1	50	13-63-07-001	Retainer Plug	1
28	13-05-02-010	Steel Ball 5/32(M3.97)	1	43-17-04-50C	Anvil Shank CP(Incl. Index No.48,49&50)	(1CP)	
29	13-08-03-203	Spring 3.6X8(0.5)	1	MI-16M(3/8)			
30	13-17-03-008	Hex.Socket Head Cap Screw M3X8	1	48	43-17-31-501	Anvil Shank	1
32	13-62-02-038	Housing Cover Packing	1	49	13-08-05-039	Socket Retainer	1
34	43-17-02-370	Rear End Plate	1	50	13-08-05-038	Retainer Rubber Ring	1
35	13-01-04-001	Bearing 6000	1	43-17-31-50G	Anvil Shank CP(Incl. Index No.48,49&50)	(1CP)	
36	13-06-02-106	Spring Pin 2.5X6	1	MI-16M(3/8PS)			
37	43-17-02-390	Rotor	1	48	43-17-33-500	Anvil Shank	1
38	13-71-10-010	Vane	6	49	43-17-33-610	Retainer Pin	1
39	43-17-02-360	Liner	1	50	13-49-05-001	Retainer Plug	1
40	13-06-03-006	Spring Pin 3X6	2				
41	43-19-09-380	Front End Plate	1	43-17-33-50C	Anvil Shank CP(Incl. Index No.48,49&50)	(1CP)	
42	13-01-20-004	Bearing EE-4	1				
43	13-11-17-026	O Ring AS568-026	1	(1)	43-17-06-070	Air Inlet (NPT)	(1)
44	13-12-10-003	Oil Seal AF0437HI	1				